

Wall-mounted air intake/exhaust vent with drip

UVLA



Description

UVLA air intake/exhaust vents are designed for use in mechanical or gravity ventilation systems with heat recovery. The half-dome cowl prevents air back flow from the gusts outside. The louvres force the exhaust air flow down. The UVLA air intake/exhaust vents have a rubber seal and fitting clamps for easy installation. The product provides a highly aesthetic finish and a long service life. The product is suitable for outdoor and indoor use.

Available materials — Product code examples

UVLA -...- polished stainless steel

Product code example

Product code: **UVLA - aaa**

type _____

Ød _____

Dimensions

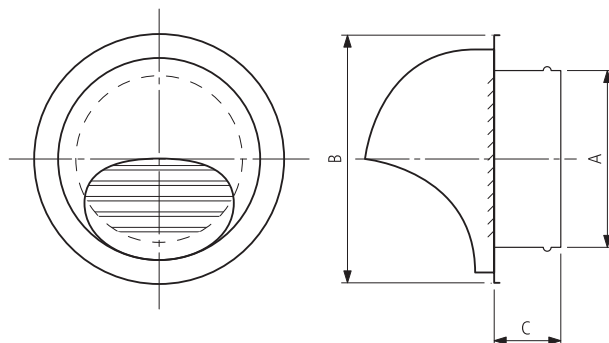

Ød (mm)	A (mm)	B (mm)	C (mm)	Effective area [m ²]
100	97	133	52	0.005
125	120	165	52	0.008
150	145	192	62	0.012
160	155	192	62	0.014
200	195	253	62	0.018

Drip styles

UVLA air exhaust vents feature a slim and a wide drip.

